

Re-usable Mask: Before You Leave the Fit Center

- Do you have two one way valves inside the mask?
- Do you have two cartridges
- Do the Tug Test to make sure your mask is snapped together

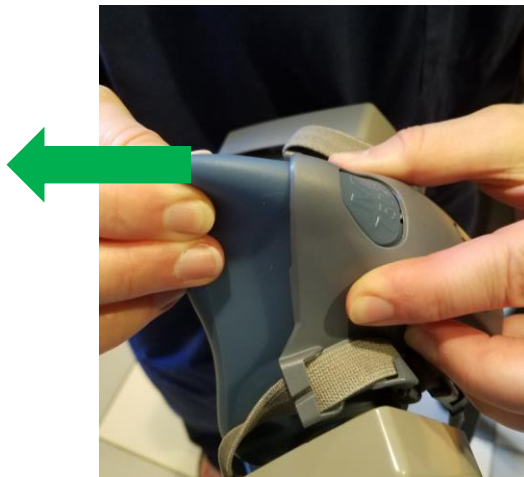

- If your mask separates with Tug test:



See Separation

- Return to Fit Center and we show you how to fix
- Fit it yourself
 - Press front & back together
 - Will see it snap back in place
 - Repeat Tug Test

